

# Maintenance guide

Help your Tylko last longer

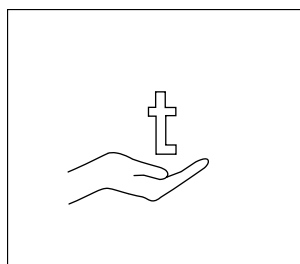

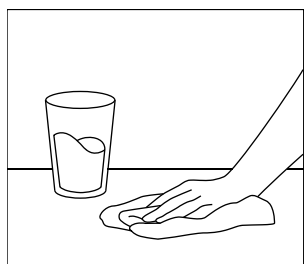
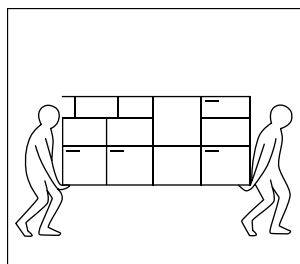
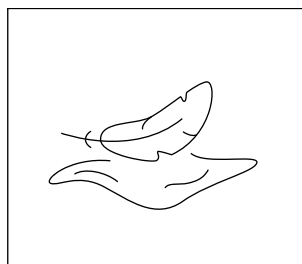
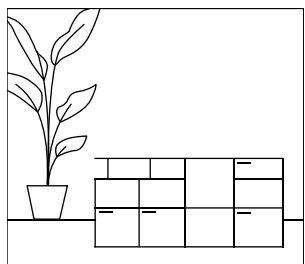

In this document, we have prepared information for you on how you can look after your furniture so that it retains its uniqueness for years to come.

Enjoy your Tylko furniture for years to come with our handy advice on cleaning, maintenance, hinge adjustment – and so much more.

**In case you do not find all the information you need, please contact us, we will be happy to answer your questions.**

EN +44 800 102 6747  
DE +49 (0) 80 000 10484  
FR +33 805 10 35 65

[hello@tylko.com](mailto:hello@tylko.com)



Wall fastening _____	3
How to take care of Tylko Shelf _____	4
Drawer adjustment - assembly _____	5
Drawer adjustment - leveling _____	7
Adjusting hinges _____	8
Feet - how to protect the floor _____	9
Let's stay in touch! _____	10

# Wall fastening

 Your shelf must be fixed to a wall to prevent serious injury or damage that may result from tipping.

## 1 Check what's behind the wall

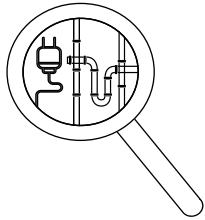

Beware of structural elements within the wall such as wiring, pipes, or building components.

If your drilling point will affect something within the wall, move to the next mounting point.

## 2 Mark the appropriate drilling depth

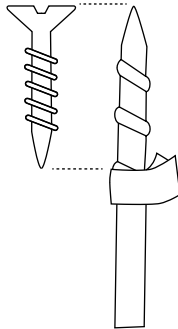

**Tip:** Use an 8mm drill bit.

**Tip:** Using the length of the screw as your guide, wrap a piece of tape around the drill bit for reference.

**Tip:** Also check the thickness of the wall in which you will be drilling

## 3 Drill a hole in the wall

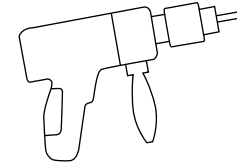

**Tip:** Use a Hoover to reduce the dust created.

## 4 Insert the supplied dowel into the wall

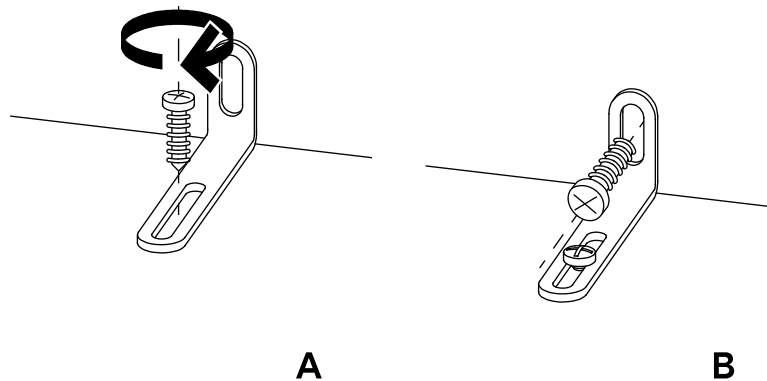
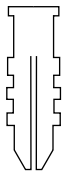

## 5 Align the bracket over the dowel and insert the supplied screw

# How to take care of Tylko Shelf

Here are a few simple guidelines to keep your Tylko looking as good as new, for as long as possible.

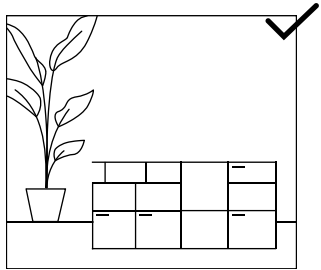

Do protect your Tylko Shelf from excessive heat and open flame.

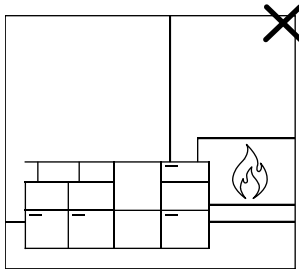

Don't place it too close to heat sources such as radiators.

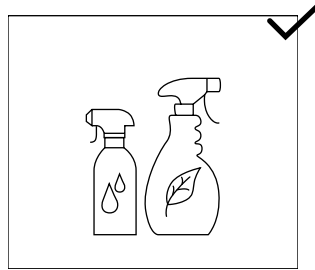

Use gentle furniture cleaners. In case of any glue residues, use isopropyl alcohol for removal.

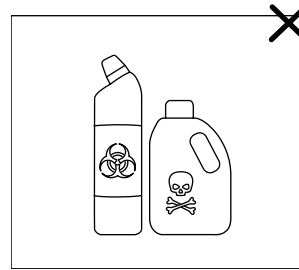

Don't use strong chemicals.

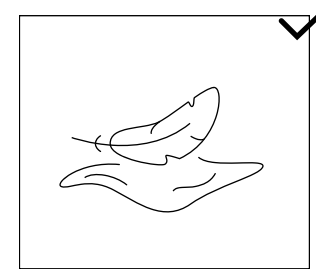

Do use a soft, moist cloth to clean it.

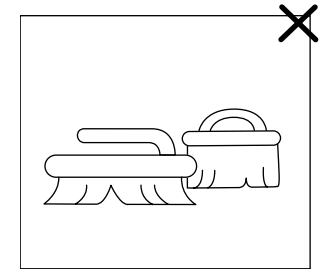

Don't use a hard scourer or brush.

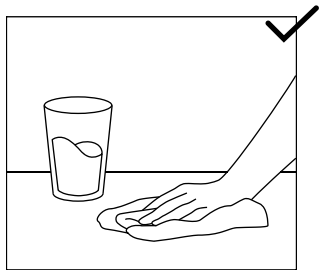

Do wipe up any spills quickly.

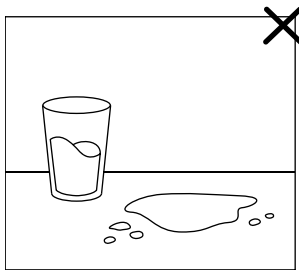

Don't let water stand on the shelf for too long.

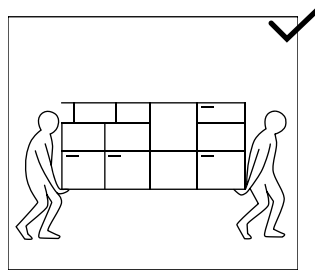

Always disassemble and assemble your shelf if you wish to move it to another place.

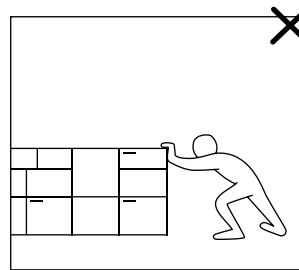

Don't move your Tylko shelf during or after it's assembled. It should always be assembled at its destination.

# Drawer adjustment - assembly

Scan the QR code to see how it works:



Page 1/2

QR codes not your thing? Visit:

<https://youtu.be/hWDpACJiRWY>

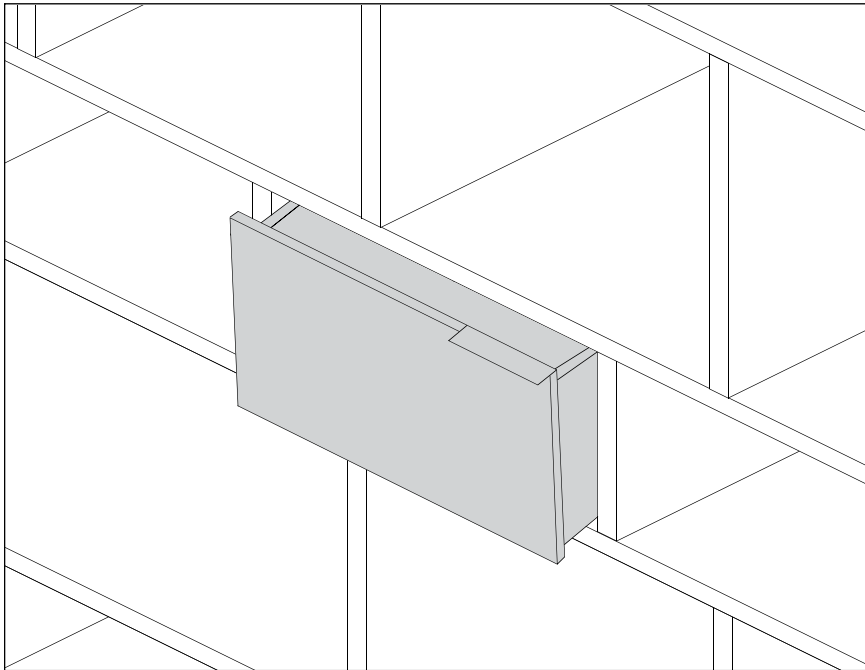

1

If a drawer is out of alignment, check if the drawer is correctly assembled.

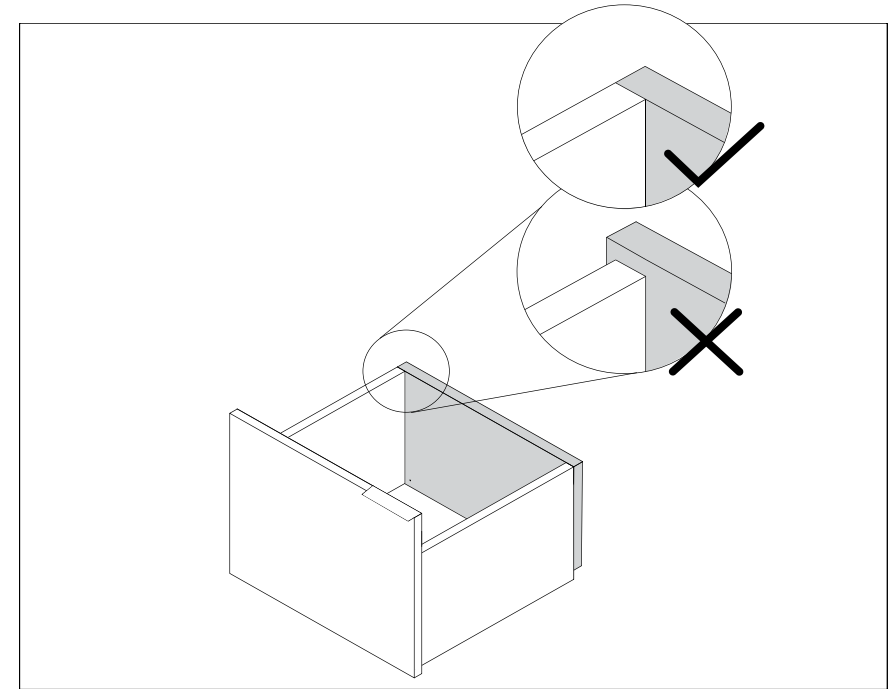

2

Check that all drawer components are correctly assembled.

Place the mounted drawer on a level surface and apply firm pressure to the side panels at the joints with the front panel, and to the back panel at the joints with the side panels.

# Drawer adjustment - assembly

Page 2/2

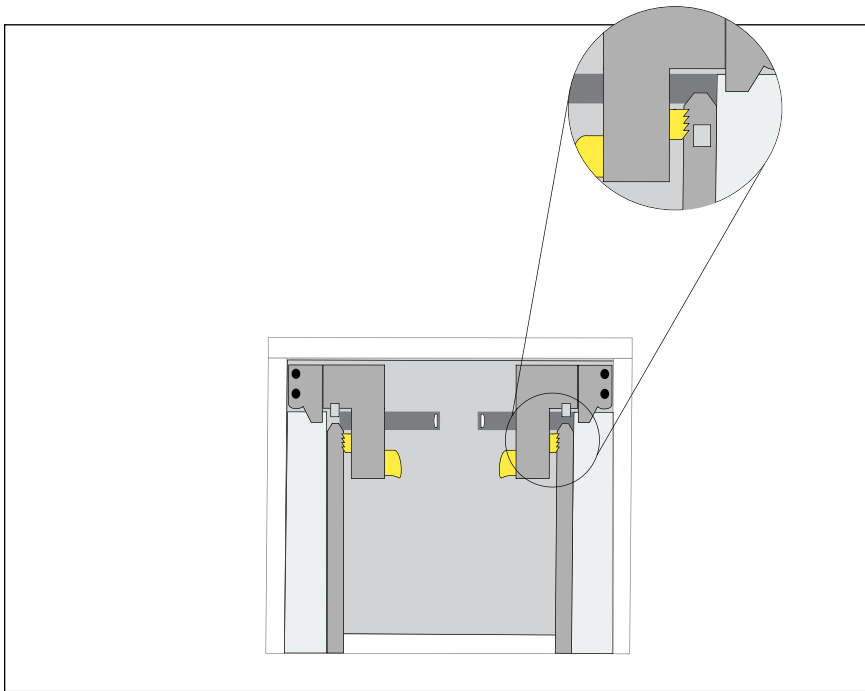

3

In a correctly assembled, the yellow teeth from the drawer rail and from the drawer connector should be connected and aligned. Look at the bottom of the drawer to confirm that the components are correctly connected on both sides.

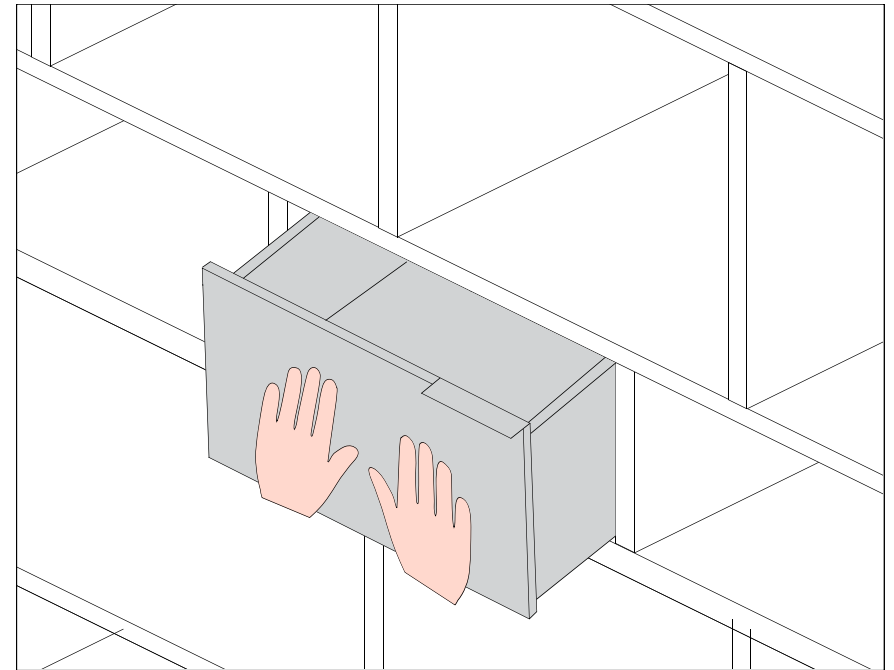

4

To fit the drawer correctly, place it into its section, align it on the rails and apply gentle downward pressure. Then slide the drawer out and press down again. Slide the drawer in and out to confirm that it closes smoothly.

# Drawer adjustment - leveling

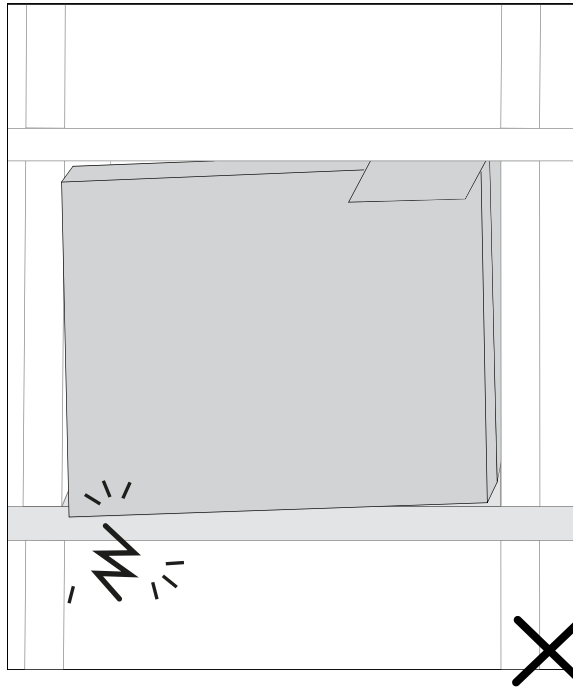

1

If after mounting, a side of the drawer rubs against the bottom element, the drawer will need to be adjusted.

**Tip:** You can level the drawer without removing it from the shelf, or, if it is more convenient for you, remove the drawer.

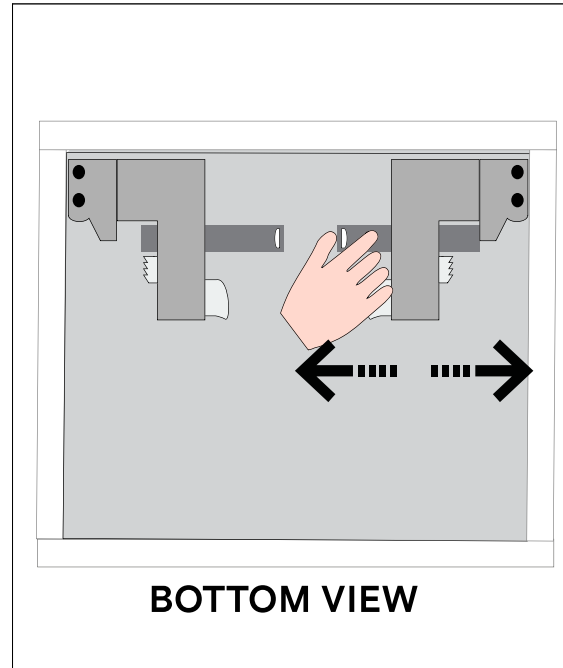

2

To adjust the drawer, adjust the black strips located near the grey elements beneath the drawer.

**Tip:** By moving the black strip towards the middle of the drawer, you raise the drawer. By moving the strip towards the outside, you lower the drawer

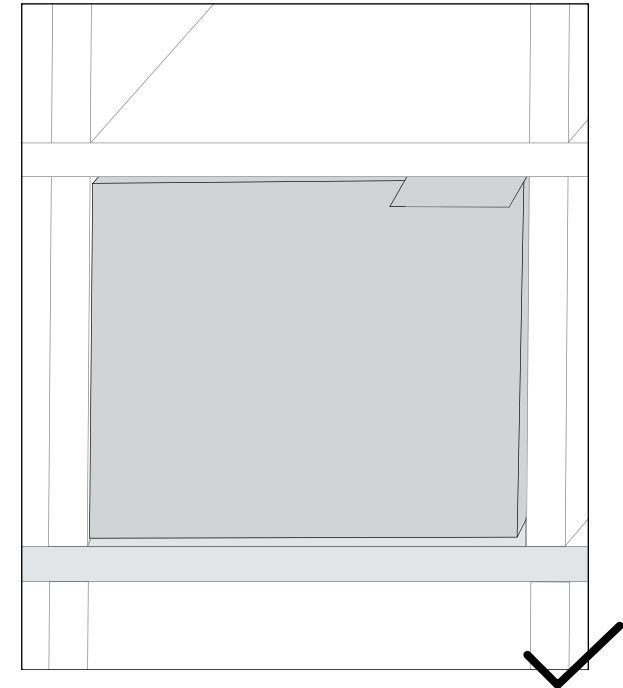

3

A correctly-assembled drawer should not rub against other unit components and is perfectly aligned with other shelf components.



# Adjusting hinges

Scan the QR code to see how it works:



Door a bit crooked or jam while closing? Here's how to adjust its position.

Before you start, prepare:   PH2

QR codes not your thing? Visit:

<https://youtu.be/faPWO84U79g>

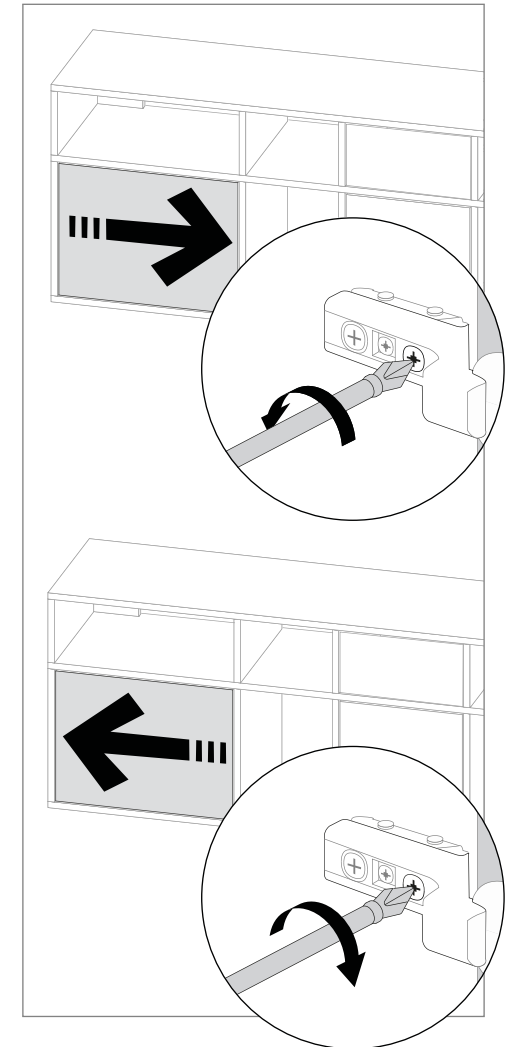
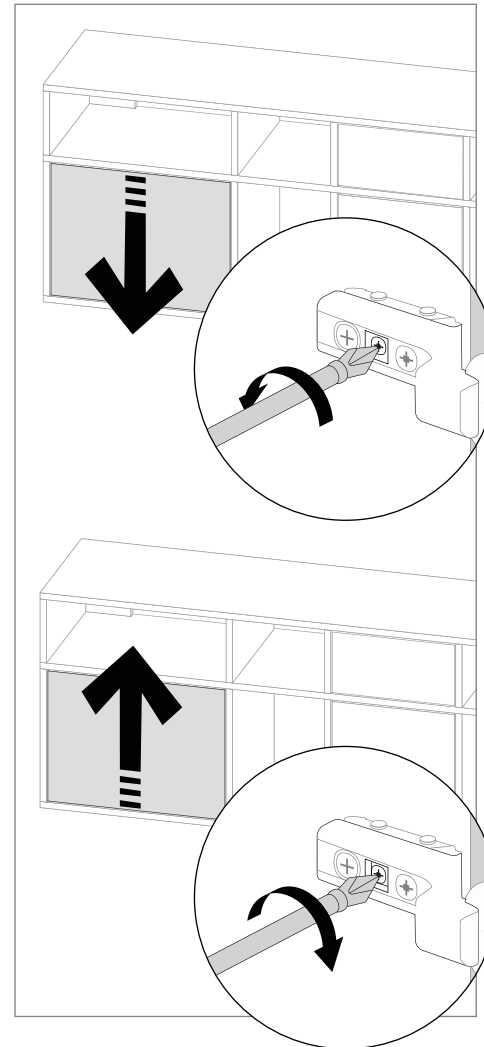
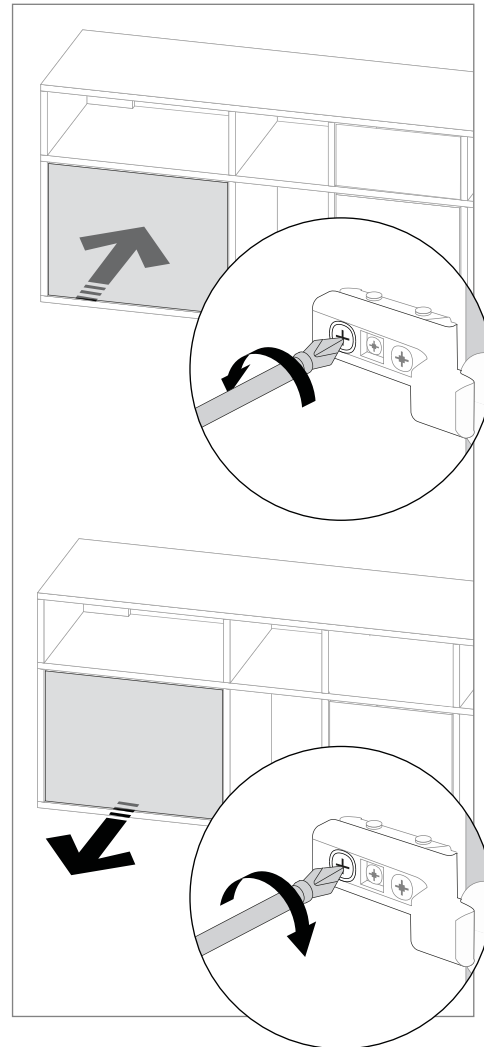
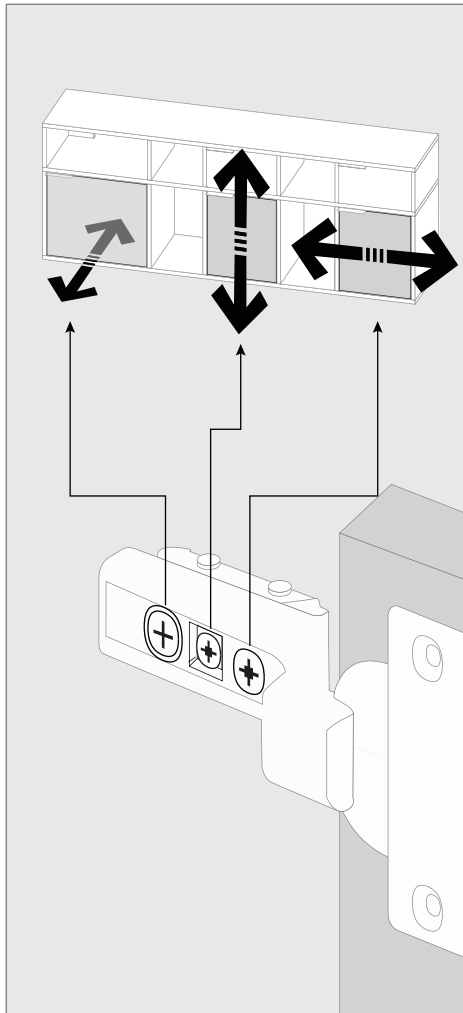

# Feet - how to protect the floor

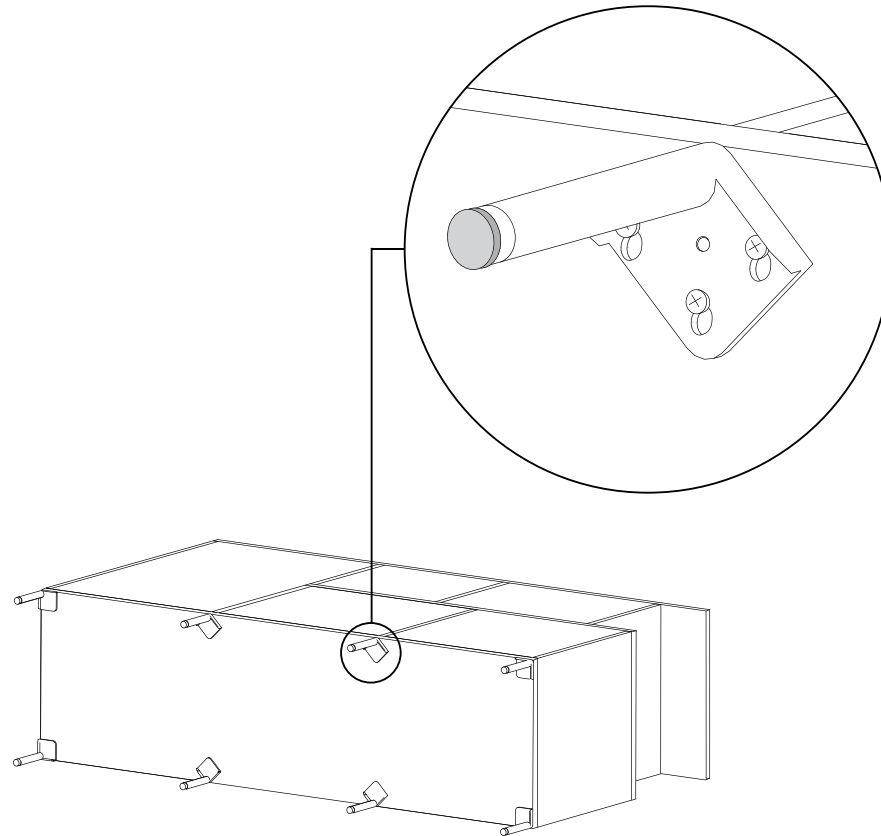

To protect your floor, you can stick felt protection on the feet. This method works best on tiled or wooden floors.

# Let's stay in touch!

Well done, not only did you design your own Tylko, you take great care of it — **to look great years later!**

Visit <http://tylko.com> to explore our full collection, and stay tuned for exciting new products.

Take care,  
the Tylko team



## Tell a friend, get £90.

Scan the code, refer a friend, everyone wins.

QR codes not your thing?  
Check out the Tylko Referral Program  
here: [tylko.com/referral-program/](http://tylko.com/referral-program/)

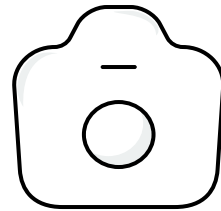

## Spread the word

Take a picture and post it online with hashtag **#myTylko**, and share your review at **tylko.com**.



## Follow us on social media

For more design and interior inspiration follow us on our social media platforms.